

List of Parts

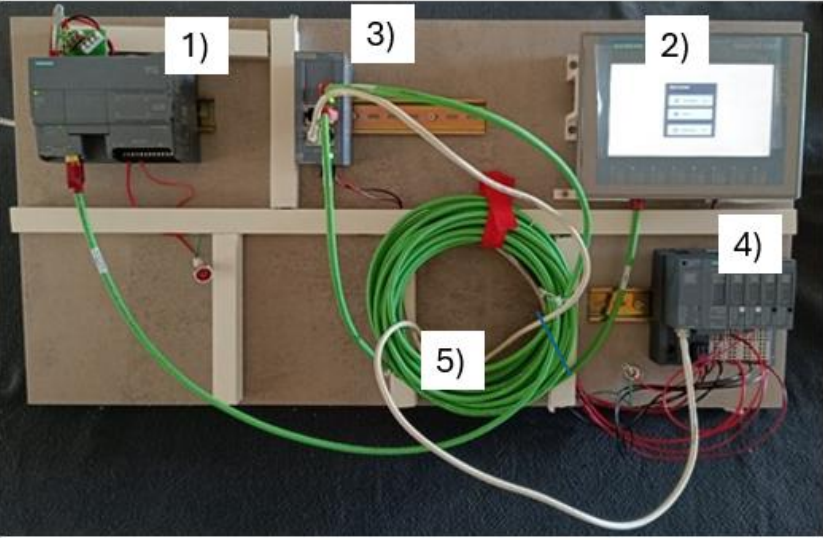

- 1. n.1 Siemens PLC of type 1215C;
- 2. n.1 Siemens HMI of type Comfort Basic;
- 3. n.1 Hub switch Simatic;
- 4. n.1 SIMATIC ET 200SP;
- 5. n.2 Ethernet cable for PLC/PC communication;

List of Tools

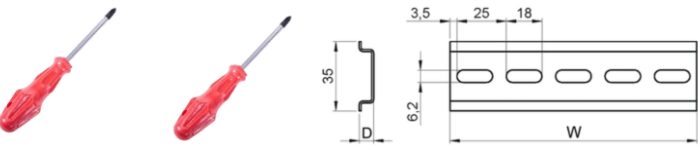

- 1. n.2 Screw driver, Philips and FlatHead;
- 2. n.32 Screw
- 3. n.3 Din 35mm guide (W=25 cm)

Procedure

- 1. Step 1: Screw the 3D printed parts (Fig 1) in their desidered position onto the board;
- 2. Step 2: Screw all the parts in their desidered position onto the board;
- 3. Step 4: Connect the parts 1, 2, 3 and 4, following the Fig.2
- 4. Step 5: Connect the parts 1 following the Fig.3
- 5. Step 6: Connect the part 4, following the Fig.4

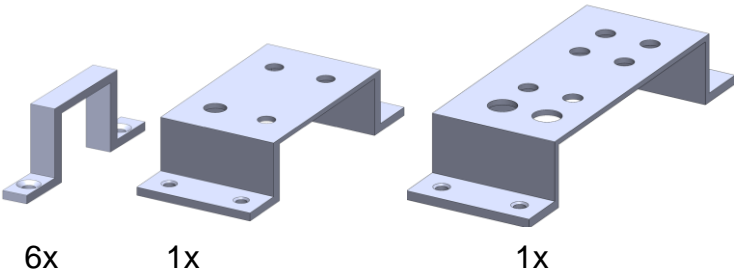

Fig 1

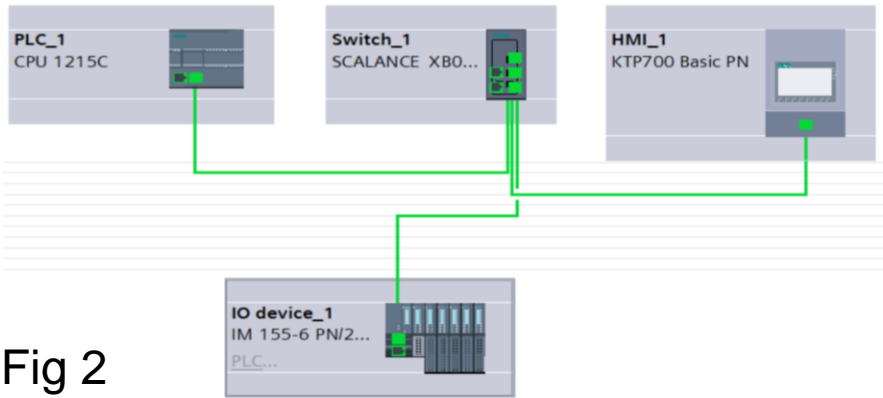

Fig 2

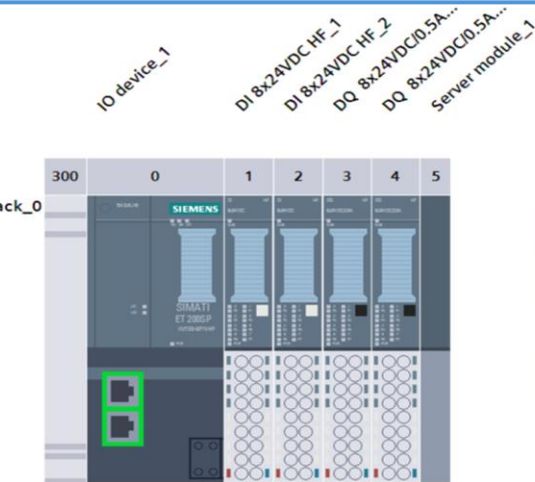
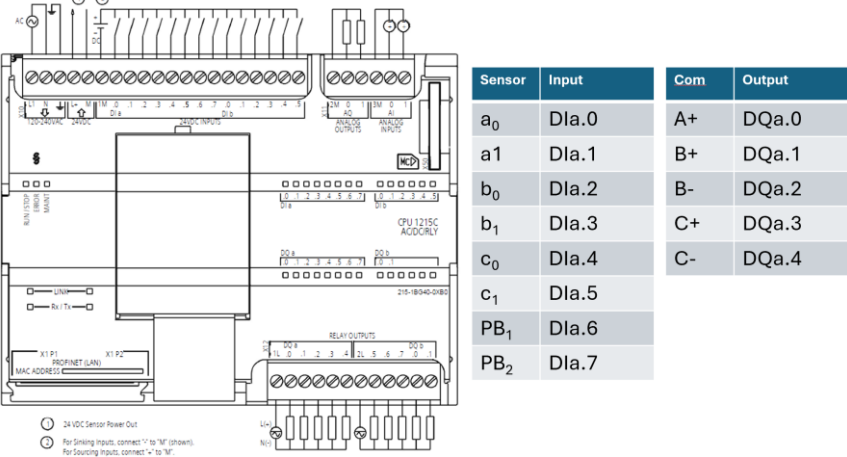

Fig 4